

IP66
ZONE 2/22

Description

Linear luminaire designed for explosion hazardous areas for ATEX zone 2/22. Body made of painted steel sheet (RAL 9016) with EPDM gasket – alternatively stainless steel AISI304 or AISI316. Cover made of opal tempered safety glass. Fitted with high quality electronic components with high LED lifetime up to 100 000 h and an efficiency of 154 lm/W. Characterized by high splash and dust resistance IP66. Suitable for ambient temperatures from -20 °C to +60 °C (depending on luminaire variant). Silicone-free design. Designed to be mounted or suspended.

Specifications

Operating voltage:

220-240 V / 50/60 Hz AC, 220-240 V DC

Source:

LED, 4000K, CRI +80, MacAdam3

Housing:

Painted steel sheet RAL 9016

Cover:

OP – tempered opal safety glass

Spotlight:

Painted steel sheet RAL 9016

Fastening:

Direct fixing to the ceiling or wall of the illuminated space, fixing to the ceiling using ceiling brackets, cable suspension on two steel lugs

Connection:

Screwless three-pole terminal block, max. wire cross-section 2.5 mm²

Standard equipment:

1x gland for cable diameter 7-12 mm, 1x gland plug, 2x hanging eye, 2x rubber gasket

Calculated lifetime – LED modules:

L80B10 Ta 40 – 70 000 h

L70B10 Ta 40 – 100 000 h

SALUKA-N-LED, MULTISALUKA-N-LED, SALUKA-N-LED-Em

(FTZU 17 ATEX 0027X)

 II 3G Ex nR IIC T6 Gc

 II 3D Ex tc IIIC T80°C Dc

On request

6500K – colour temperature

MULTI – permanent emergency lighting (1h, 3h)

DIM – dimmable electronic ballast (DALI)

1/3F – single-phase or three-phase connection, max. conductor cross-section 2.5 mm²

GESIS – possibility to equip the luminaires with connectors

NEREZ – body made of stainless steel sheet AISI304 or AISI316 (for NEREZ version lower ambient temperature by approx. 5-10 °C)

Variants

Number items	Name of variant	Luminous flux (lm)	Specific power luminaires	Power input (W)	Ta (°C)	Dimensions A x B x C (mm)
42076	SALUKA-N-LED-OP-1250-218-G2-4K, IP66	1155	144 lm/W	8	-20°C≤ta≤45°C	705 x 192 x 90
42079	SALUKA-N-LED-OP-2500-218-G2-4K, IP66	2220	148 lm/W	15	-20°C≤ta≤60°C	705 x 192 x 90
42082	SALUKA-N-LED-OP-5000-218-G2-4K, IP66	4409	152 lm/W	29	-20°C≤ta≤55°C	705 x 192 x 90
42085	SALUKA-N-LED-OP-2500-236-G2-4K, IP66	2220	148 lm/W	15	-20°C≤ta≤60°C	1305 x 192 x 90
42088	SALUKA-N-LED-OP-5000-236-G2-4K, IP66	4440	153 lm/W	29	-20°C≤ta≤60°C	1305 x 192 x 90
42091	SALUKA-N-LED-OP-10000-236-G2-4K, IP66	8819	152 lm/W	58	-20°C≤ta≤50°C	1305 x 192 x 90
42094	SALUKA-N-LED-OP-3750-258-G2-4K, IP66	3330	151 lm/W	22	-20°C≤ta≤55°C	1605 x 192 x 90
42097	SALUKA-N-LED-OP-7500-258-G2-4K, IP66	6661	151 lm/W	44	-20°C≤ta≤55°C	1605 x 192 x 90
42100	SALUKA-N-LED-OP-12550-258-G2-4K, IP66	11305	153 lm/W	74	-20°C≤ta≤45°C	1605 x 192 x 90
42103	SALUKA-N-LED-OP-16700-258-G2-4K, IP66	14175	149 lm/W	95	-20°C≤ta≤50°C	1605 x 192 x 90
42106	SALUKA-N-LED-OP-20000-258-G2-4K, IP66	16963	145 lm/W	117	-20°C≤ta≤45°C	1605 x 192 x 90

Luminous flux and luminaire power tolerance ±10%

You can view the variant detail via the item number.

Accessories

Set of pole brackets Ø 60 mm (2"), M8, AISI304 (2 pcs)

Item number: **75312**
Product type: **051100**

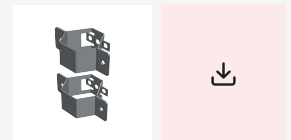

Set of pole brackets Ø 50 mm (1 1/2"), M8, AISI304 (2 pcs)

Item number: **75313**
Product type: **051101**

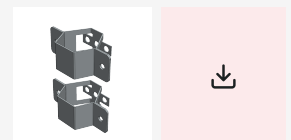

Set of pole brackets Ø 42 mm (1 1/4"), M8, AISI304 (2 pcs)

Item number: **75314**
Product type: **051102**



Set of pole brackets Ø 60 mm (2"), M8, AISI316 (2 pcs)

Item number: **75315**
Product type: **051103**

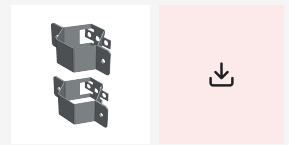
**Set of pole brackets Ø 50 mm (1 1/2"), M8, AISI316 (2 pcs)**

Item number: **75316**
Product type: **051104**

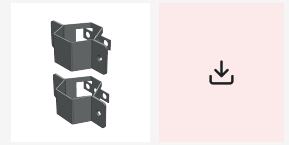
**Set of pole brackets Ø 42 mm (1 1/4"), M8, AISI316 (2 pcs)**

Item number: **75317**
Product type: **051105**

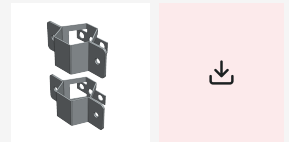
**EXTEND/SALUKA ceiling fixings set (2 pcs)**

Item number: **3583**
Product type: **051139**

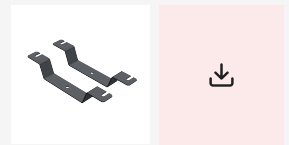
**Stainless steel wall arm SALUKA AISI304 – 60 °C (1 pc)**

Item number: **3591**
Product type: **051147**

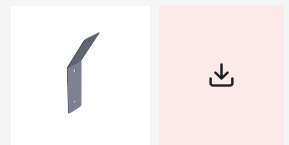
**Set of adjustable holders SALUKA (2 pcs)**

Item number: **28788**
Product type: **063754**

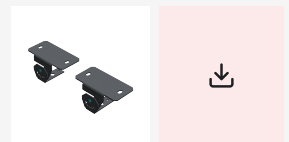

© 2026 All rights reserved. VYRTYCH a.s. does not warrant the accuracy or completeness of the information provided herein and is not responsible for any events that may occur as a result of unqualified reliance on this information. The information contained herein does not constitute a commercial offer and does not form part of a quotation or contract, unless confirmed by VYRTYCH a.s..